

CRUSH  
RESISTANT  
RIBBING

3/8

WALL

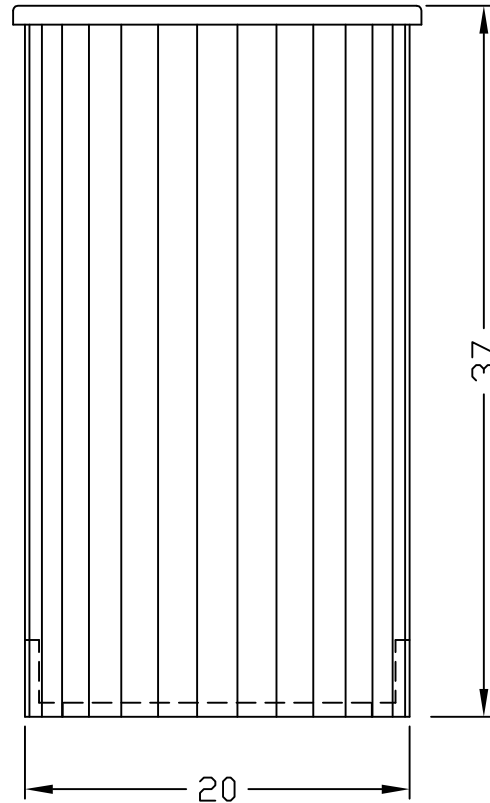
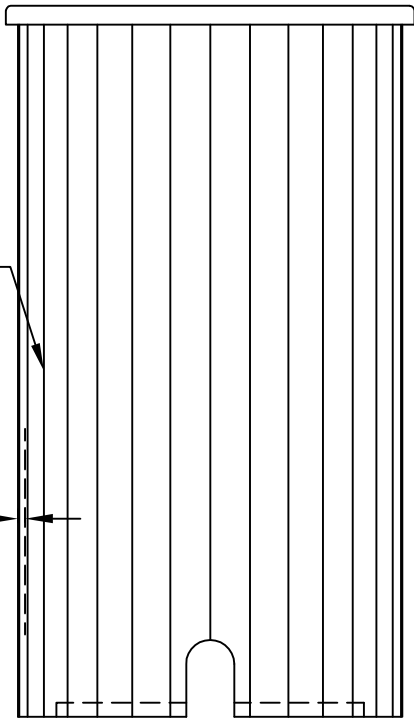

NOTES

- 1) DIM'S  $\pm 1/8$  U.N.O.
- 2) WALL THICKNESS:  $3/8 \pm 5\%$



DFW PLASTICS, INC.  
1001 JARVIS RD  
FORT WORTH, TX. 76179  
(817) 439-3600  
(817) 439-3700 (f)  
www.dfwplasticsinc.com

DFW-2036

FILE NAME:

\*  
\*

UPDATED: 08/15/2010

DRAWN BY: J.C.A.

PLOT SCALE: 1:10