

Ø6 3/8 x 1/4 DEEP RECESS FOR AMR PAD
W/ Ø1.88 x 2.50 SLOT TOUCH READ HOLE

TAPPED
HOLD

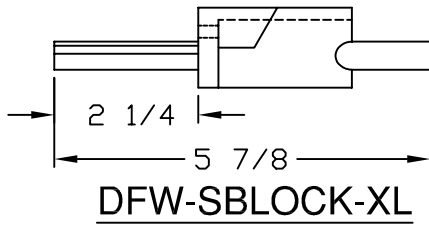

DFW-SBLOCK-XL

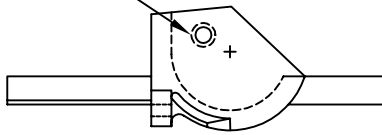
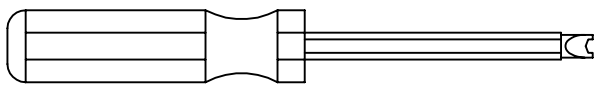

DFW-SDRIVER

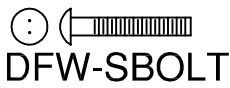

DFW-SBOLT



DFW-SPRING

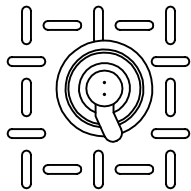

DFW-S-BOLT INSTALLED

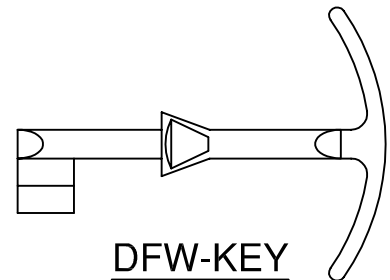
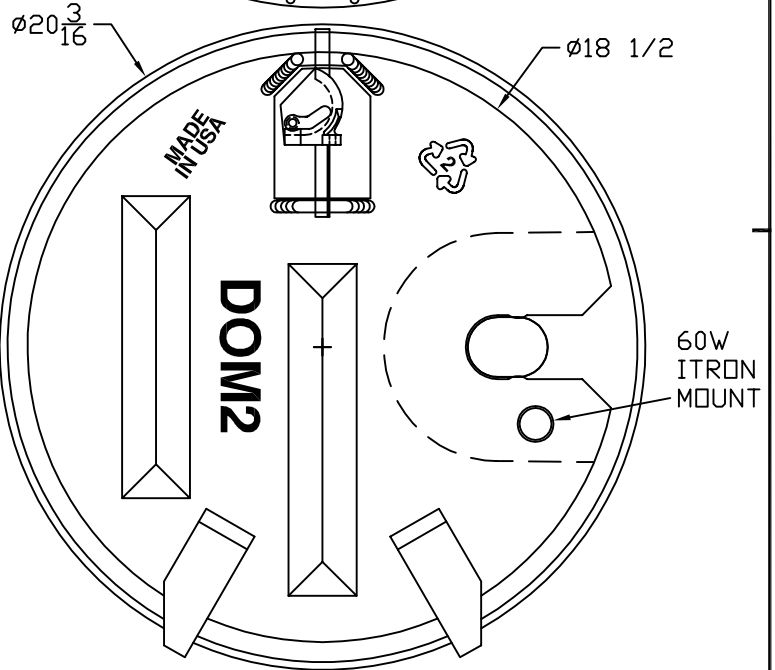

DFW-KEY

NOTES:

- 1) DIM'S ± 1/8 U.N.O.
- 2) SNAP LOCK POCKET WILL RECIEVE ITRON ERT. SNAP LOCK SLOT IS 1.80" ±.015 TO ALLOW FOR A FINGER FORCE INSTALL. POCKET HEIGHT IS 1 5/8" FOR MIN 1/8" AIR GAP.
- 3) DESIGNED FOR DOMESTIC CAST IRON RING.



DFW PLASTICS, INC.
1001 JARVIS RD
FORT WORTH, TX. 76179
(817) 439-3600
(817) 439-3700 (f)
www.dfwplasticsinc.com

DFW20AMRD-1SAT ITRON-LID

FILE NAME:
DFW20AMRD-1BAT ITRON
-LID.DWG

UPDATED: 07/08/2010

DRAWN BY: J.C.A.

PLOT SCALE: 1:6